

Place

An initial sustainable mix of apartments, maisonettes, detached and semi-detached homes and terraces. The flexibility of the housetypes allows the mix to adapt to demand quickly and without undue cost.



View 2



View 1

Accommodation Schedule

Unit variation	Dwelling type	Area (m ²)	% of units	No. units	No. bedspaces
A	4 bedroom house	133m ²	7.6%	19	76
B	4 bedroom house	142m ²	16%	40	160
C	3 bedroom house	110m ²	26.8%	67	201
D	2 bedroom apartment	57m ²	17.6%	44	88
	2/3 bedroom maisonette	74m ²	17.6%	44	88
E	2/3 bedroom live/work unit	84m ² /48m ² wk	14.4%	36	72
				250	685

Types

One unit type / many house types. Each house can be simply adapted, according to demand, into 2 apartments, a live/work unit or traditional family house. All house types have large areas of window, a 2.7m floor to ceiling height and private outdoor space

1:200



Rear Elevation Front Elevation Rear Elevation Front Elevation Rear Elevation Front Elevation Rear Elevation Front Elevation



Second Second Second Second Second

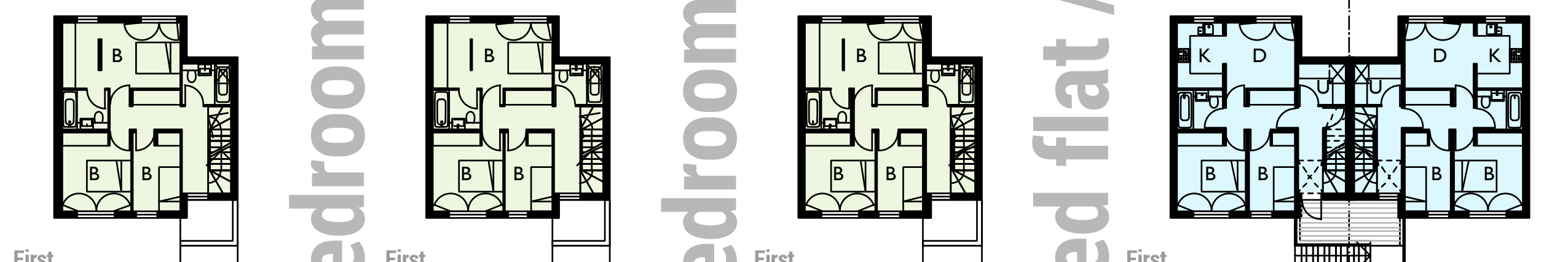

First First First First First

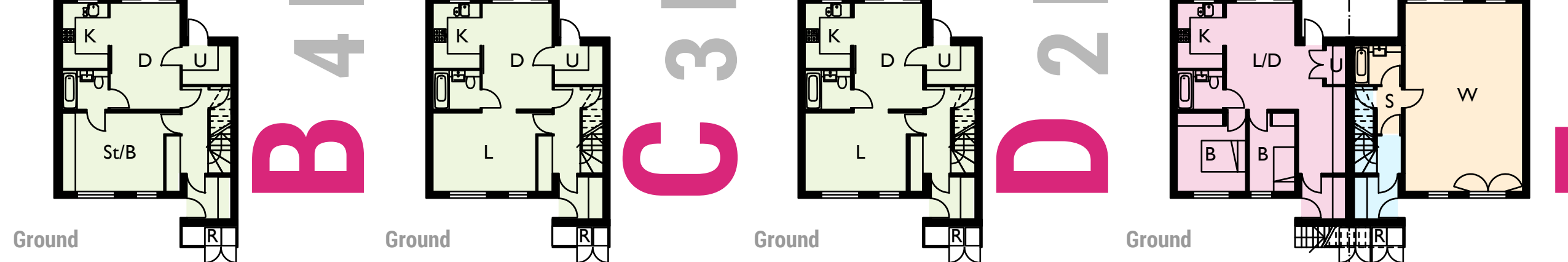

Ground Ground Ground Ground Ground

A 4 bedroom house

B 4 bedroom house

C 3 bedroom house

D 2 bed flat / 2 bed maisonette

E 2 bed live/work unit

Accommodation Schedule

- Legend
- B Bedroom
 - D Dining
 - K Kitchen
 - L Living
 - R Recycle / refuse
 - S Storage
 - St Study
 - U Utility
 - W Workspace

Unit variation	Dwelling type	Area (m ²)
A	4 bedroom house	133m ²
B	4 bedroom house	142m ²
C	3 bedroom house	110m ²
D	2 bedroom apartment	57m ²
	2/3 bedroom maisonette	74m ²
E	2/3 bedroom live/work unit	84m ² /48m ² wk